



**Pooja Sane Guruji Vidya Prasarak Mandal's
S. I. Patil Arts, G. B. Patel Science and S.T.K.V. Sangh
Commerce College, Shahada, Dist. Nandurbar,
(Maharashtra)**

**NAAC Re-accredited 'A' Grade, RUSA Beneficiary College
& DBT Star College**

***DEPARTMENT OF MATHEMATICS
AND STATISTICS***



***Department Profile
(2016-2021)***

1. Name of the Department	:	MATHEMATICS & STATISTICS
2. Year of Establishment	:	1970
3. Courses/ Programmes offered	:	B.Sc., M.Sc., Ph.D., Certificate Course in "Mathematics in Economics"

4. Teaching posts (sanctioned and filled):

Post	Sanctioned	Filled
Professor	00	00
Associate Professor	00	00
Assistant Professor	04	02
Others (CHB)	07	04

5. Faculty profile with name, qualification, designation, experience etc:

Name	Qualification	Designation	Specialization	Experience	Ph.D. student guided
Dr. C. S. SUTAR	MSc, Ph.D.	Head & Asst. Professor	Mathematics	14	4
Mr. G. S. PATIL	M.Sc. (NET)	Asst. Professor	Mathematics	05	-
Mr. P. S. PATIL	M.Sc. (SET)	CHB	Mathematics	04	-
Miss. M. S. MAHANUBHAV	M.Sc.	Contractual	Mathematics	02	-
Miss. S. B. PATIL	M.Sc.	Contractual	Mathematics	02	-
Miss. S. C. PATIL	M.Sc.	Contractual	Mathematics	01	-

6. Students Profile (2016-2022)

1. Statistics

Year	No. of Students
2016-2017	55
2017-2018	100
2018-2019	91
2019-2020	70
2020-2021	45
2021-2022	103

2. Mathematics

Year	UG			PG	
	FY	SY	TY	Part-I	Part-II
2016-17	84	58	32		
2017-18	139	66	25		
2018-19	156	69	38	21	
2019-20	161	107	37	27	19
2020-21	73	92	55	29	25
2021-22	125	60	34	30	29

7. Ratio of Teacher to Students: 1:119

8. Meritorious Students

UNIVERSITY LEVEL

Sr. No.	Name of the student	Year	Class	Rank
1	AHIRE SHIVANI SANJAY	2016-17	T.Y.B.Sc.	1

2	KHAN UZMA VIKAR AHMAD	2019-20	M.Sc.	1
3	METKAR SONALI RAJENDRA	2020-21	T.Y.B.Sc.	2
4	PATEL VIJAY BHATU	2020-21	T.Y.B.Sc.	3
5	SHINDE DEVYANI UTTAM	2020-21	T.Y.B.Sc.	3

COLLEGE LEVEL

Year	Name of Students	%
UG-B.Sc. Mathematics		
2016-17	AHIRE SHIVANI SANJAY	96.90 %
2017-18	MORE HARSHADA MOHANRAJ	84.55 %
2018-19	PATIL HEMANGI DINESH	91.17 %
2019-20	JANGID SUNITA SURESHKUMAR	91.53 %
2020-21	METKAR SONALI RAJENDRA	95.75 %
2021-22	NARBHAVAR GAUTAMI RAJESH	93.88 %
PG-M.Sc. Mathematics		
2018-20	KHAN UZMA VIKAR AHMAD	86.25 %
2019-21	PATIL SHITAL CHHOTULAL	87.85 %
2020-22	CHAUDHARI MALVIKA JAGDISH	87.20 %

9. Result data of the assessment period:

Year	TYBSC			MSC: Part-II		
	Appeared	Pass	Percentage	Appeared	Pass	Percentage
2016-17	32	17	53.12			
2017-18	25	17	68			
2018-19	38	29	76.31			
2019-20	37	37	100	18	17	94.44
2020-21	55	55	100	25	25	100

10. Infrastructural facilities:

- a. Library: Departmental Library is maintained by the staff. It contains 91 books.
- b. Internet facility for staff and students: Yes, Wi-fi enabled
- c. Laboratories:

27.5ft × 26.25ft area of laboratory

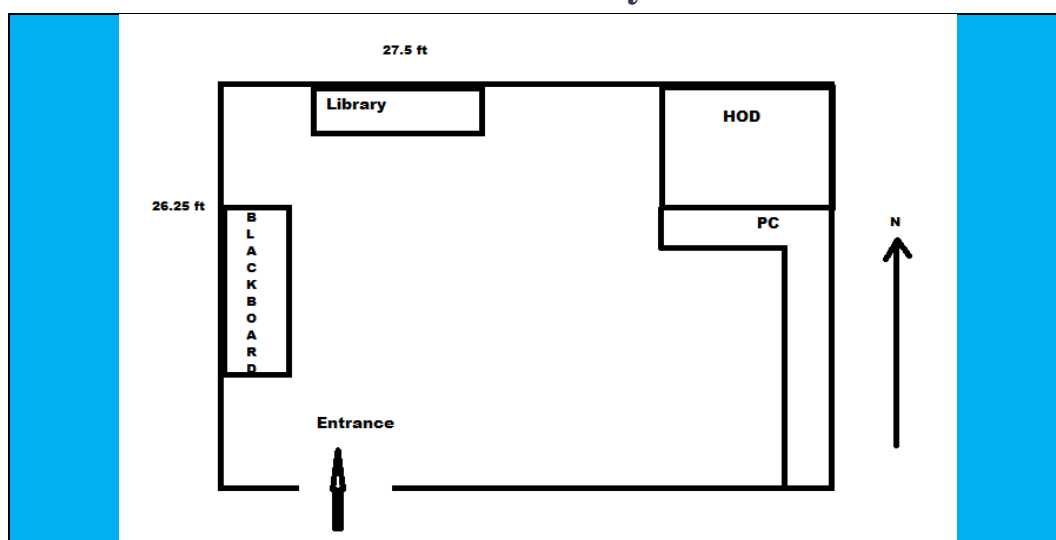

11. List of Research Associates working:

No. of Students Ph.D. awarded: 01

No. of Research Scholars: 03

1	Mrs. Kamini Kiran Chaudhari: Research Guide: Dr. C. S. Sutar Reg. No. : KBCNMU/11/Ph.D./Math./679/2018 Title of the Research: "Behavior of Hyperbolic Heat Conduction in Thermoelastic Media" Status: Awarded (2022)
2	Ms. Sangita Baburao Pimpare Research Guide: Dr. C. S. Sutar Reg. No. : KBCNMU/11/Ph.D./Math./680/2018 Title of the Research: "Analysis of Some Thermoelastic Problems In Circular Solid Bodies" Status: Thesis Submitted (2022)
3	Mr. Sandip Namdeo Patil Research Guide: Dr. C. S. Sutar Reg. No. : KBCNMU/11/Ph.D./Math./681/2018 Title of the Research: "Recent Techniques in the Study of Thermoelastic Models with Engineering Applications" Status: Ongoing

4	Mrs. Madhuri Dilip Sonje Research Guide: Dr. C. S. Sutar Reg. No. : KBCNMU/11/Ph.D./Math./729/2020 Title of the Research: “Study Of Mathematical Models of Heat Transfer in Human Organs” Status: Ongoing
----------	--

12. Areas of research interest :

Thermoelasticity, Mathematical Biology.

Details of Ph.D. guide, PG Teacher recognition of faculties:

Name of the faculty	Letter/Ref. No.	Mode	University
Dr. C. S. Sutar	NMU/11/PGR/714/2018 dated 31-01-2018	By Research	KBCNMU, Jalgaon

13. Publications by Faculty:

Sr. No.	Name of Faculty	Publications in peer reviewed/UGC Care Listed journals	Citations/	h-index	i10 index
1	Dr. C. S. Sutar	15	21	2	1

14. Seminars/ Conferences/Workshops Organized/ attended:

Name of Faculty	Seminars/ Workshops/ Conferences	OC/ RC/ FDP attended
Dr. C. S. Sutar	27	02
Mr. G. S. Patil	18	02

15. Membership of the Professional bodies/ Journals:

Name of Faculty	Name of the Body/ Journal	Position held
Dr. C. S. Sutar	Indian Mathematical Society	Life Member

16. Seminars/ conferences/ workshops organized by the Dept:

Sr. No.	Name of Conference/ Seminars / Workshops	No. of Participants	National/ University	Dates
1	<i>National Workshop on NET/SET</i>	47	National	04-05 Jan-2018
2	<i>Talent Search in Mathematics TSM-2018 (Sep-2018)</i>	330	University	08/09/2018 & 30/09/2018
3	<i>National Mathematics Day-2018</i>	59	College	22 nd Dec-2018
4	<i>Madhava Mathematics Competition</i>	82	National	06 th Jan-2019
5	<i>Talent Search in Mathematics TSM-2019 (Sep-2019)</i>	570	University	04-09-2019 & 14-09-2019
6	<i>National Conference on Mathematics and Applications in Real World</i>	113	National	21 st Feb-2020 to 22 nd Feb-2020
7	<i>Online national workshop on preparation of IIT-JAM exam in Mathematics</i>	294	National	27 th Jan-2021 to 31 th Jan-2021
8	<i>Madhava Mathematics Competition (Feb-2021)</i>	01	National	07 th Feb-2021
9	<i>National Mathematics Day-2021</i>	152	National	22 nd Dec-2021
11	<i>Talent Search in Mathematics TSM-2022 (Mar-2022)</i>	142	University	03 rd March-2022

17. Participation of Students in Various Activities:

Sr. No.	Name	Event	Level	Date
1	Patil Aarti Mohan	Avishkar-2018	University	02 nd -03 rd Jan-2019
2	Patil Shital Chhotulal	Avishkar-2018	District	26 th Dec-2018
3	Patil Shubhangi Yogesh	Avishkar-2019	District	30 th Dec-2019
4	Patil Shital Chhotulal	Avishkar-2018	University	02 nd -03 rd Jan-2019
5	Patil Sanskruti Ravindra	Aryabhatta National Maths Competition	National	30 th June-2022
6	Aandhale Bhagyashri Dilip	Science Quiz	State	07 th July 2021

18. List the teaching methods and Innovative Practices adopted by the faculty:

Interactive lecture method using blackboard, Group discussions, Problem solving sessions, Seminars, HA.

19. List of distinguished Alumni of the department during the assessment period (maximum 10):

S. No	Name of Alumni	Passing year	Qualifications held	Designation and Working place	Contact
1	PATEL VIJAY BHATU	2021	TYBSC	M.Tech: Wipro-Work integrated Learning Programmes-Pune	7972920876
2	JANGID SUNITA SURESHKUMAR	2022	Msc	Cognizant-Programmer Trainee	9156126578

20. SWOC analysis of the department and Future plans:

Strengths:

- Facilities for UG, PG and Ph. D. education
- Qualified, experienced & research-spirited faculty
- University recognized well equipped research laboratory
- Good research outcome with less availability of funds
- Active participation in Social activities (Tree Plantation, Election Duties etc.)
- Voluntary involvement of students in co-curricular & extra-curricular activities.
- Organization of "Talent search in Mathematics" to motivate knowledge in Mathematics.

Weakness:

- 70% population is a tribal in habitat.
- Students are weaker in language of medium of instructions.
- Non availability of major industries in the vicinity.

Opportunities:

- Well-groomed campus and supportive management.
- Better job opportunities in industrial as well as teaching sectors.

Challenges:

- To make available research funds from various agencies.
- Soft skill development programs for students.
- Development of e-learning resources.
- Conduction of Courses or workshops like data science, Machine learning etc.

Future plans of the department:

- Promote more research activities.
- Adopt e-learning pedagogy.
- Introduction of Certificate Courses on Data science.
- Organize International level Conferences for students.
- Increase progression to higher education and placement.



Nandurbar, MH, India
 NH 752G, Shahade, Nandurbar,
 425409, MH, India
 Lat 21°34'12"N, Long 74°28'56"E
 06/28/2021 10:15 AM



13-01-2020 3:11pm

13-01-2020 3:11pm

28-02-2020 1:29pm



28-02-2020 1.33pm



06-03-2020 4:24 pm



02-03-2022 11:20 pm



Nandurbar, MH, India
Shahade, Nandurbar, 425409,
MH, India
Lat 21°34'15"N, Long 74°29'2"E
12/22/2021 02:37 PM

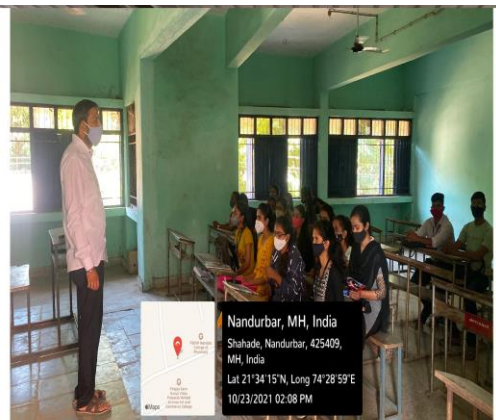

Nandurbar, MH, India
Shahade, Nandurbar, 425409,
MH, India
Lat 21°34'15"N, Long 74°28'59"E
10/23/2021 02:08 PM

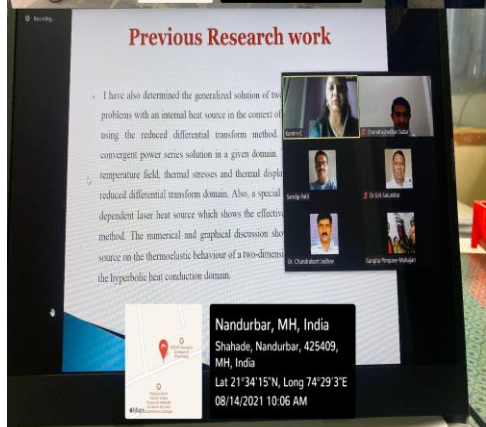

Nandurbar, MH, India
Shahade, Nandurbar, 425409,
MH, India
Lat 21°34'15"N, Long 74°29'3"E
08/14/2021 10:06 AM

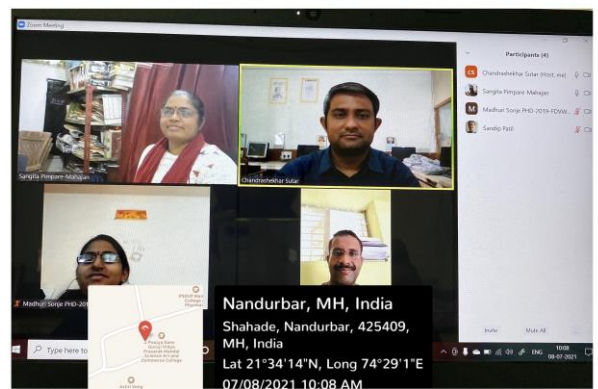

Nandurbar, MH, India
Shahade, Nandurbar, 425409,
MH, India
Lat 21°34'14"N, Long 74°29'1"E
07/08/2021 10:08 AM