



RUSA BENEFICIARY & DBT STAR STATUS INSTITUTE

P.S.G.V.P.MANDAL'S

**S.I.PATIL ARTS, G.B.PATEL SCIENCE  
AND S.T.K.V. SANGHCOMMERCE  
COLLEGE, SHAHADA,  
DIST - NANDURBAR.**



# **Departmental Profile**

**2016-22**







**DEPARTMENT OF GEOGRAPHY**

<b>1. Name of the Department</b>	<b>: Geography</b>
<b>2. Year of Establishment</b>	<b>: 1970</b>
<b>3. Courses/ Programmes offered</b>	<b>: UG- 1970 PG - 1996 Ph.D. - 2014</b>

**4. Teaching posts (sanctioned and filled):**

Post	Sanctioned	Filled
<b>Professor</b>	00	00
<b>Associate Professor</b>	00	01
<b>Assistant Professor</b>	00	03
<b>Others (CHB)</b>	00	03

**5. Faculty profile with name, qualification, designation, experience etc.:**

Name of faculty	Qualification	Designation	Specialization	Teaching Experience (years)	Photo
Dr. U. V. Nile	M.A. Ph.D.	Associate Professor	Population & Settlement	30	
Dr. P. R. Torawane	M.A. B. Ed NET-JRF, PhD	Assistant Professor	Population & Settlement	15	
Prof. R. V. Patil	M.Sc.,SET, NET	Assistant Professor	Economic Geography	06	
Miss. M. N Patel	M.Sc., NET, SET	CHB Teacher	Population & Settlement	14	
Prof. V. U. Pawara	M.Sc., NET,SET	CHB Teacher	Population & Settlement	03	
Prof. B. D. Patil	M.Sc., NET	CHB Teacher	Population & Settlement	01	

**6. Non-teaching staff: Lab Attendant – 01, Peon-01**

## 7. Programmes offered

Sr. No.	Programme level	Name of the Programme	Entry Qualification	Medium of Instruction	Sanctioned Student Strength	Number of Students
1	UG	B. A. Geography	H S C or Equivalent	Marathi	480	-
		B. Sc. Geography	H S C or Equivalent	English	FY:240 SY:120	196 114
2	PG	M.A./M. Sc. Geography	B.A./B. Sc. Geography	English	20/year	18

## 8. Highlights of the department

- Courses from XI to Post Graduation
- Highly Qualified Staff
- Good Infrastructure
- Innovative Practical demonstrations
- State of art Teaching Aids
- Research Activities

### Student Strength:

Year	Faculty	No. of Students						
		UG				PG		
		FY	SY	TY	Total	Part-I	Part-I	Total
2016-17	BA	145	36	22	203	15	16	31
	B.Sc.	230	105	-	335	-	-	-
	B.Com.	15	-	-	15	-	-	-
2017-18	BA	124	20	19	163	18	15	33
	B.Sc.	265	102	-	367	-	-	-
	B.Com.	15	-	-	15	-	-	-
2018-19	BA	195	19	11	225	16	17	33
	B.Sc.	359	108	-	467	-	-	-
	B.Com.	36	-	-	12	-	-	-
2019-20	BA	140	36	12	188	18	12	30
	B.Sc.	306	221	-	527	-	-	-
	B.Com.	12	-	-	36	-	-	-
2020-21	BA	66	15	25	106	09	18	27
	B.Sc.	154	241	-	395	-	-	-
	B.Com.	05	-	-	05	-	-	-
2021-22	BA	131	22	16	169	18	11	29
	B.Sc.	196	114	-	310	-	-	-
	B.Com.	12	-	-	12	-	-	-

## Results:

Year	T.Y. B.A			M.A./M.Sc (Part-II)		
	Registered students	Pass students	Percent age	Registered students	Pass students	Percentage
2016-17	22	22	100	10	09	90
2017-18	12	12	100	14	12	88.88
2018-19	12	12	100	16	16	100
2019-20	12	10	83.33	12	12	100
2020-21	20	20	100	15	15	100

## 9. Membership of the Professional bodies/ Journals:

Name of Faculty	Name of the Body/ Journal	ISSN	Position held
Dr. U. V. Nile	Maharashtra Bhugolshastra Parishad, Deccan Geographer	-	Life Member
Dr. P. R. Torawane	Maharashtra Bhugolshastra Parishad,	-	Life Member

## 10. List the teaching methods/Innovative Practices adopted by the faculty:

- Interactive lecture method using blackboard, Group discussions, Problem solving sessions, Seminars, HA,
- Use of LCD Projector for PG Students to support lectures

## Conference & Workshop Organized by Department:

Sr. No.	Title	Date	Level (University /National/ International)	Name of Coordinator
1	SYBSc (CBCS) –Geography Syllabus Restructuring Workshop	26/2/19	University Level	Dr. U. V. Nile
2	National e-Conference on “ The New Era in Geography: Geoinformatics”	12/2/21	National Level	Dr. G. S. Khandagale

## Publications by Faculty members:

Sr. No.	Name of Faculty	Publications in peer reviewed journals	Books/ Chapters
1	Dr. U.V,Nile	96	13
2	Dr. P.R.Torawane	19	06
3	Mr. R.V.Patil	07	-
	<b>TOTAL</b>	<b>122</b>	<b>19</b>

## 11.Infrastructure of the Department: Physical Facilities:

Sr. No.	Room/ laboratory/ classroom	Dimensions	Utilization for
1	Laboratory I	40x23	UG & PG Practical
2	Laboratory II	48x49	UG & PG Practical
3	Computer Lab	24x11	PG Practical
4	Department	48x21	Staff

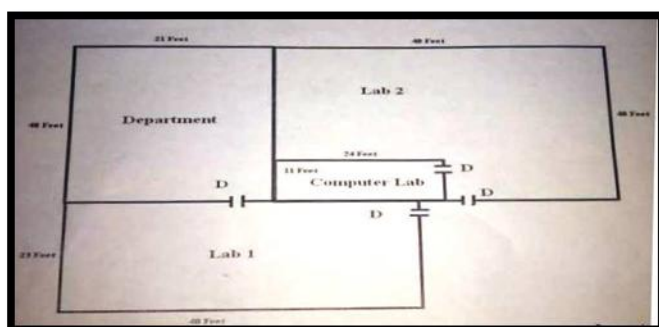

## Computers and other peripherals:

Sr. No.	Item	Description	Number
1	Computers	Intel Pentium E5500	08
2	Printers	Canon – EBP2900B	01
3	Scanners	HP Scan jet G2410	01
4	Modem/ Router	D Link	01

## 12. No of Ph.D Student Awarded/Working:

Research Guide: Dr. U. V. Nile

S.N	Name of Scholar	Registration No and Date	Title of Research	Award Date
1	Dr. Bhavsar Sandip Subhash	161011148 16/10/2011.	Dimension of Tribal Transformation In Dhule District: A Geographical Appraisal”	17/2/2019
2	Dr.Padavi AmsyaTetya	NMU/11/Ph.D/Geog/35/2013. 05-06-2013.	Geographical Study of Non Timber Forest Products In Western Satpura Region of Nandurbar District	2/1/2020.
3	Dr. Vasave Mohan Arjun	NMU/11/Ph.D/Geog/32/2013 05-06-2013.	Sustainability of Tribal Handicrafts In Nandurbar District.	31/7/2021
4	Dr. Patil Anil Murlidhar	No/GUG/PhD /166	Nandurbar Jilhyatil Sardar Sarovar Praklpamule Badhit Loksankhyechi Vaishishte	5/2/022

### List of Research Associates working under Dr. U. V. Nile:

Sr. no	Name of Scholar	Registration No and Date	Title of The Research Work
1	MrYashod Raju Zavrao	NMU/11/ Ph.D /Geog/32/2013.05-06-2013.	A Geographical Study Of Potential Tourist Centers In Nandurbar District.
2	Gawali Santosh Bapurao	PHD-2017-OT8P73 21-05-2018.	A Geographical Study Of Agro Tourism Centers In Pune Division, Maharashtra.
3	Manohar Bansilal Patil	PHD-2017-NOZ 1 FA 14-02-2019.	Geo-Socio-Economic Analysis of Rurban Centers In Nandurbar District.
4	Ganesh KallaValvi	Phd-2019-	Impact Of Geographical Factors On Rural Settlements In Akkalkuwa Tahsil Of Nandurbar District, Maharashtra,
5	Mina Narottam Patel	Phd-2019-496 Ktp	A Role Of Irrigation In Agricultural Development In Nandurbar District

**13. List of distinguished Alumni of the department during the assessment period (maximum 10):**

Sr.No.	Name	Designation
1	VALVI TEMBRYA POHALYA	Assistant Professor, Vasantnao Naik College ,Shahada
2	PADVI DHIRSING RODTYA	Assistant Professor, Vasantnao Naik College ,Shahada
3	KUWAR MONIKA RAVINDRA	Teacher, MMSS'S Voluntary Arts,Comm.& Sci. Junior College ,Shahada
4	VALVI AJIT NORTYA	L.L.B. The Modern Education Society's New Law College, Mumbai(M.H)
5	MALIS BHARAT BHAGWAN	Data Entry Operator ,Sarangkheda PHC
6	GUNJAL SUNIL RAJENDRA	Teacher, Private Tuition Classes, Aurangpur
7	PAWARA DIWAN MERWAN	Common Service Centre
8	THAKARE GULAB KALUSING	Teacher, Private Tuition Classes, Navagaon
9	VASAVE SUNIL SHEMTYA	Teacher, Private Tuition Classes, Velkhedi
10	PAWARA KARAN DARASING	Teacher, Private Tuition Classes, Telkhedi

#### 14. SWOC analysis of the department and Future plans:

✓ **Strength:**

- Department having highest participation of students in study tour.
- Well equipped laboratories, geographical and GPS instruments.
- Qualified faculty including 2 Ph.D. holders, 4 NET/SET.
- Recognized Research Center by KBCNMU, Jalgaon

✓ **Weakness:**

- Students are from tribal community and it is difficult for them to adopt learning environment.
- Recruitment of Faculty as per work load is less.

✓ **Opportunities:**

- Good opportunity for research and solving problems of local areas.
- Start Certificate Course in GIS, Remote Sensing and 'Tourism Management'.

✓ **Challenges:**

- Quality education to Socio-economically backward students from Tribal regions.
- To increase research facilities.
- To provide campus placement for Geography students.